

2. WARNING! 24KG

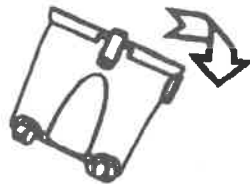

4. Moist Cloth



Vacuum Inlet

6. Blower Outlet



Storage

Store the vacuum cleaner in a cool dry place. It is recommended to empty and clean the drum before storing for a lengthy period of time.

Service

If service becomes necessary within the warranty period, the appliance should be returned to an approved Home of Living Brands (Pty) Ltd Service Centre. Servicing outside the warranty period is still available however this will be chargeable. Use only recommended spare parts and accessories on the vacuum cleaner for maximum efficiency.



**PLEASE RETAIN YOUR PROOF OF PURCHASE/
RECEIPT IN THE EVENT OF A CLAIM UNDER
WARRANTY THIS RECEIPT MUST BE PRODUCED**

WARRANTY

Home of living brands (PTY) Ltd warrants to original purchaser of this product ("the customer") that this product will be free of defects in quality and workmanship which under normal personal, family or household use and purpose may manifest within a period of 1 (one) year from the date of purchase ("warranty period").

1. Where the customer has purchased a product and it breaks, is defective or does not work properly for the intended purpose, the customer must notify the supplier from whom the customer bought the product ("the supplier") thereof within the warranty period. Any claim in terms of this warranty must be supported by a proof of purchase. If proof of purchase is not available, then repair, and/or service charges may be payable by the customer to the supplier.
2. The faulty product must be taken to the supplier's service centre to exercise the warranty.
3. The supplier will refund, repair or exchange the product in terms of this warranty subject to legislative requirements. This warranty shall be valid only where the customer has not broken the product himself, or used the product for something that it is not supposed to be used for. The warranty does include and will not be construed to cover products damaged as a result of disaster, misuse, tamper, abuse or any unauthorised modification or repair of the product.
4. This warranty will extend only to the product provided at the date of purchase and not to any expendables attached or installed by the customer.
5. If the customer requests that the supplier repairs the product and the product breaks or fails to work properly within 3 (three) months of the repair and not as a result of misuse, tampering or modification by or on behalf of the customer, then the supplier may replace the product or pay a refund to the customer.
6. The customer may be responsible for certain costs where products returned are not in the original packaging, or if the packaging is damaged. This will be deducted from any refund paid to the customer.

Home of Living Brands (Pty) Ltd
www.homeoflivingbrands.co.za
011 490 9600
031 303 1163
021 552 5161



INSTRUCTIONS/WARRANTY



**MODEL:HWD20
WET,DRY,BLOW TRIO-VAC**

S12684AE

Operating Instructions.

Important Safety Instructions.

Before using the vacuum cleaner, always read the operating instructions and keep them readily available.

Purpose and Intended Use.

The vacuum cleaner described in this operating manual is suitable for private use, e.g. household, hobby, workshop, car cleaning and sucking up dust and liquids.

Name and Parts Location.

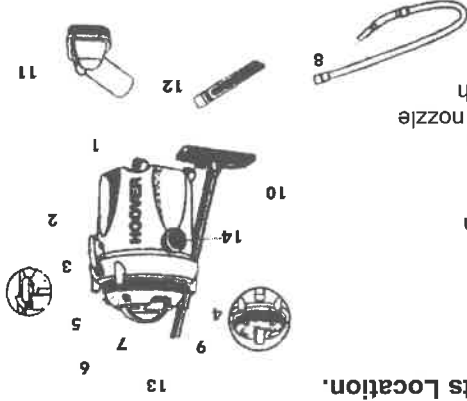

1. Castor Wheels
2. Drum
3. Latch
4. Cord Storage
5. Motor housing
6. ON/OFF Switch
7. Handle
8. Flexi hose
9. Extension tube
10. Carpet / Floor nozzle
11. Furniture brush
12. Crevice tool
13. Blow outlet
14. Suction inlet

Warning

- If the supply cord is damaged, it must be replaced by the manufacturer, its service agent or similarly qualified persons in order to avoid a hazard.
- This appliance is not intended for any use by persons (including children) with reduced physical, sensory or mental capabilities, or lack of experience and knowledge, unless they have been given supervision or instruction concerning the use of the appliance by a person responsible for their safety.
- Children should be supervised to ensure that they do not play with the appliance.

The following materials should not be picked up by the vacuum cleaner.

- Hazardous Dust
- Hot materials (burning cigarettes, hot ash, etc.)
- Flammable, explosive or aggressive liquids (e.g. petrol, solvents, acids, alkalis, etc.
- Flammable or explosive dust (e.g. magnesium or aluminium dust, etc.)

Before Start-up.

- Ensure that the voltage shown on the rating plate corresponds to the voltage of the local Mains power supply.
- It is recommended that the vacuum cleaner should be connected via a residential current circuit breaker.
- Inspect the power cord regularly to detect signs of damage, e.g. cracks or ageing. A damaged power cord must be replaced by an authorised person. Never use the vacuum cleaner if the filter is damaged.

Operating your Hoover HWD 20Wet/Dry vacuum cleaner:

Blow Function.

1. Unwind the power supply cord from the cord storage.
2. Attach the flexi hose to the blow outlet and attach the desired nozzle to the flexi hose.
3. Switch the vacuum cleaner ON by depressing the ON/OFF switch.
4. To switch the vacuum cleaner OFF depress the ON/OFF switch again and then remove from the mains power supply.

4. The suction power will reduce and stop as the drum fills up. It is recommended to empty the drum on a regular basis.
5. To switch the vacuum OFF depress the ON/OFF switch again and then remove from the mains power supply.

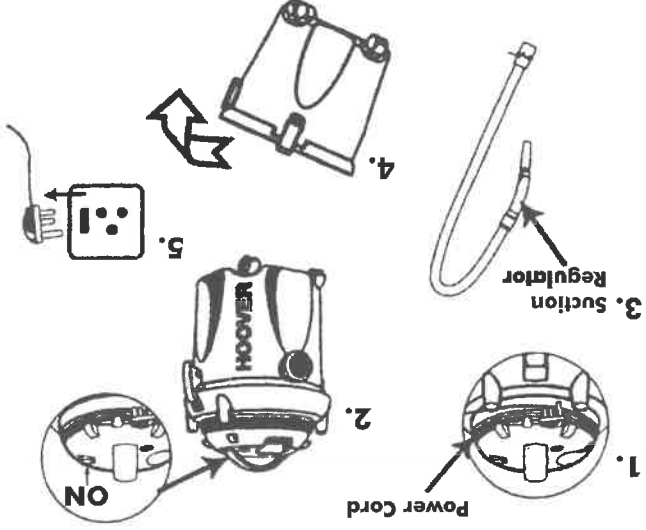

Picking up Liquids

Before liquids are picked up, always remove the filter bag. If foam develops or liquid emerges, stop work immediately and empty the drum.

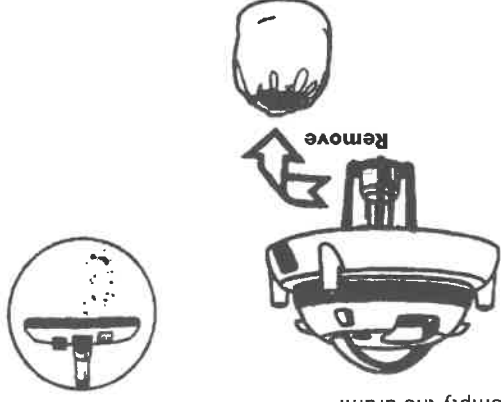

Maintenance, Cleaning and Repair.

1. Disconnect the plug from the mains power supply before cleaning.
2. Take care when emptying the drum, as when full it could weigh up to 24kg.
3. Release the two latches located on the drum in order to remove the motor housing.
4. Empty the drum using the handle grip located on the underside of the drum. Clean with a warm moist cloth and buff dry. Do not use harsh abrasives or other cleaning aids to clean the vacuum cleaner.
5. Clean the filter periodically by gently beating it over a rubbish bin. If cleaning is not done the suction power of the vacuum will decrease.
6. After cleaning the vacuum cleaner, place the motor housing on the drum and secure the two latches back into place. For correct assembly of motor housing to drum, ensure that the vacuum inlet and the blower outlet line up vertically.
7. Never spray water over the upper section of the vacuum cleaner.

